

Property Summary

Tax Year: 2025

| | | | | | |
|------------------|-------------------|----------------------|---------------------------|-------------------------|---------------------------------------|
| REID | 8451 | PIN | 5688-48-4324 | Property Owner | BATTS, NED EUGENE |
| Location Address | 622 LENNINGTON LN | Property Description | LT 140 LAURCOUR FARMS S/D | Owner's Mailing Address | 622 LENNINGTON LN WASHINGTON NC 27889 |

| Administrative Data | | Transfer Information | | Property Value | |
|-----------------------|---------------------|---------------------------|-----------|---|-----------|
| Plat Book & Page | | Deed Date | 4/24/2012 | Total Appraised Land Value | \$25,774 |
| Old Map # | NONE | Deed Book | 001781 | Total Appraised Building Value | \$268,396 |
| Market Area | 1011 | Deed Page | 00356 | Total Appraised Misc Improvements Value | \$6,559 |
| Township | Washington Township | Revenue Stamps | | Total Cost Value | \$300,729 |
| Planning Jurisdiction | BEAUFORT | Package Sale Date | | Total Appraised Value - Valued By Cost | \$300,729 |
| City | | Package Sale Price | | Other Exemptions | |
| Fire District | NORTHSIDE FIRE | Land Sale Date | 6/9/2005 | Exemption Desc | |
| Spec District | RES 02 | Land Sale Price | \$185,500 | Use Value Deferred | |
| Land Class | SINGLE FAMILY RES | Improvement Summary | | Historic Value Deferred | |
| History REID 1 | | Total Buildings | 1 | Total Deferred Value | |
| History REID 2 | | Total Units | 0 | Total Taxable Value | \$300,729 |
| Acreage | 0.27 | Total Living Area | 1,792 | | |
| Permit Date | | Total Gross Leasable Area | 0 | | |
| Permit # | | | | | |

Building Summary

Card 1 622 LENNINGTON LN

| Building Details | |
|-------------------------|-----------------|
| Bldg Type | RESIDENTIAL |
| Units | 1 |
| Living Area (SQFT) | 1792 |
| Number of Stories | 2.00 |
| Style | CONVENTIONAL |
| Foundation | BRICK |
| Frame | |
| Exterior | ALUM, VINL |
| Const Type | GABLE |
| Heating | AIR-DUCTED |
| Air Cond | CENTRAL |
| Baths (Full) | 3 |
| Baths (Half) | 1 |
| Extra Fixtures | 0 |
| Total Plumbing Fixtures | 11 |
| Bedrooms | 4 |
| Floor | SHEET VINYL |
| Roof Cover | ASPHCOMP SHG |
| Roof Type | |
| Main Body (SQFT) | 136 |

| Building Description | | | |
|----------------------|------|-----------------------------|------|
| Year Built | 2005 | Effective Year | 2005 |
| Additions | 9 | Remodeled | 0 |
| Interior Adj | | Prefab Fireplaces (1.00) | |
| Other Features | | | |

| Building Total & Improvement Details | |
|--------------------------------------|--------------|
| Grade | C+10 110% |
| Percent Complete | 100 |
| Total Adjusted Replacement Cost New | \$294,941 |
| Physical Depreciation (% Bad) | AVER 9% |
| Depreciated Value | \$268,396 |
| Economic Depreciation (% Bad) | 0 |
| Functional Depreciation (% Bad) | 0 |
| Total Depreciated Value | \$268,396 |
| Market Area Factor | 1 |
| Building Value | \$268,396 |
| Misc Improvements Value | \$6,559 |
| Total Improvement Value | \$274,955 |
| Assessed Land Value | |
| Assessed Total Value | |

| Addition Summary | | | |
|------------------|----------------------|------|------|
| Story | Type | Code | Area |
| 1.00 | FINISHED GARAGE | FGR | 502 |
| 1.00 | FINISHED OPEN PORCH | FOP | 231 |
| 1.00 | FINISHED STORAGE | FST | 48 |
| 1.00 | WOOD DECK | WDD | 118 |
| 1.00 | BASE AREA | BAS | 757 |
| 1.00 | BASE AREA | BAS | 22 |
| 1.00 | BASE AREA | BAS | 60 |
| 1.00 | BASE AREA | BAS | 60 |
| 1.00 | FINISHED UPPER STORY | FINU | 757 |

Building Sketch

Photograph

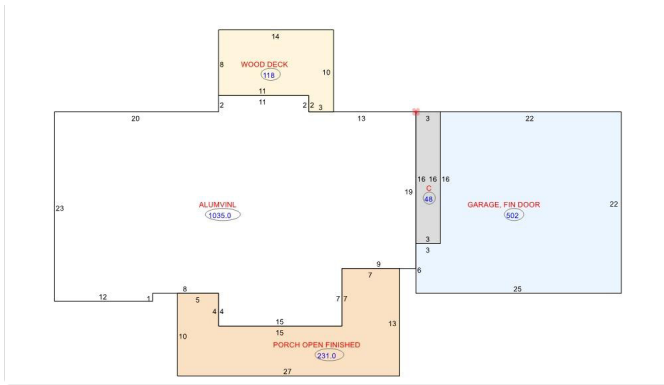

Misc Improvements Summary

| Card # | Unit Quantity | Measure | Type | Base Price | Size Adj Factor | Eff Year | Phys Depr (% Bad) | Econ Depr (% Bad) | Funct Depr (% Bad) | Common Interest (% Good) | Value |
|---|---------------|------------|--------|------------|-----------------|----------|-------------------|-------------------|--------------------|--------------------------|---------|
| 1 | 14x20 | DIMENSIONS | GARAGE | \$34.45 | 1 | 2009 | 32 | 0 | 0 | | \$6,559 |
| Total Misc Improvements Value Assessed: \$6,559 | | | | | | | | | | | |

Land Summary

| | | | | | | | |
|-------------------------------------|------------|----------------|------------------------|----------|------------------------|-----------------|------------|
| Land Class: SINGLE FAMILY RES | | | Deeded Acres: 0 | | Calculated Acres: 0.27 | | |
| Zoning | Soil Class | Description | Size | Rate | Size Adj. Factor | Land Adjustment | Land Value |
| NONE | | Res Build Site | 0.27 BY THE ACRE PRICE | \$37,000 | 2.58 | | \$25,774 |
| Total Land Value Assessed: \$25,774 | | | | | | | |

Ownership History

| | Owner Name | Deed Type | % Ownership | Stamps | Sale Price | Book | Page | Deed Date |
|---------|---|-----------|-------------|--------|------------|--------|-------|-----------|
| Current | BATTS, NED EUGENE | DEED | 100 | 0 | | 001781 | 00356 | 4/24/2012 |
| 1 Back | BATTS, NED EUGENE JR/ BATTS, REMANDA FAYE | DEED | 100, 100 | 371 | \$185,500 | 001459 | 00149 | 6/9/2005 |
| 2 Back | SHORELINE BUILDERS INC | DEED | 100 | 40 | \$20,000 | 001447 | 00648 | 4/11/2005 |

Notes Summary

| Building Card | Date | Line | Notes |
|---------------|------|------|-------|
| No Data | | | |